

THIS DRAWING IS UNPUBLISHED. RELEASED FOR PUBLICATION
 © COPYRIGHT BY TYCO ELECTRONICS CORPORATION. ALL RIGHTS RESERVED.

Loc	DIST	REVISIONS			
P	LTR	DESCRIPTION	DATE	DWN	APVD
FT	64	AA1	REV PER ECO-06-018765	4-12-07	DH DB

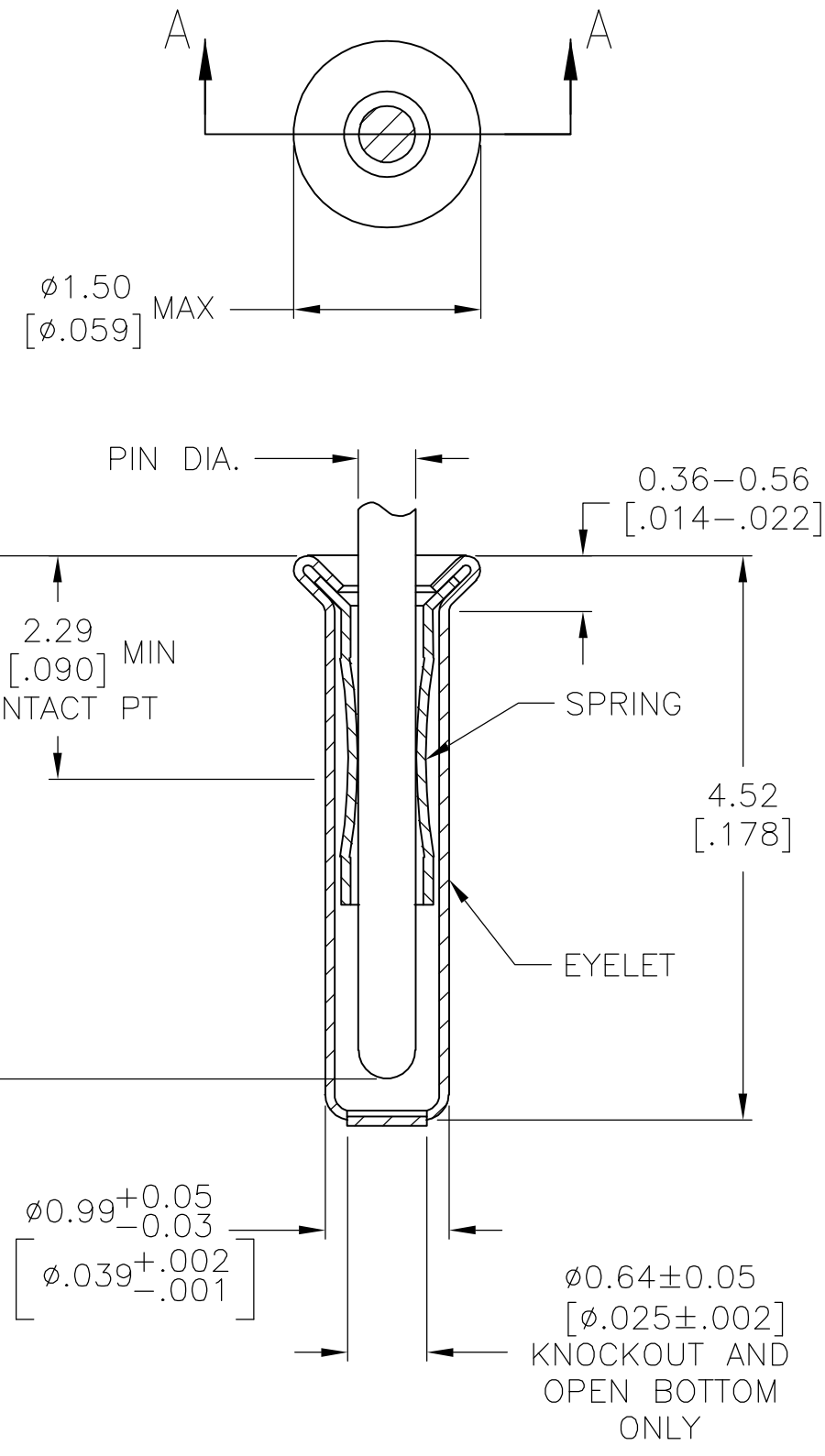

SECTION A-A

- 1. TIN PER MIL-T-10727 OR TIN LEAD .000254 [.000100] MIN THK.
- 2. GOLD PER MIL-G-45204, TYPE II, 0.00076 [.000030] MIN THK OVER NICKEL PER QQ-N-290 0.00028 [.000011] MIN THK ON CONTACT AREA.
- 3. GOLD FLASH PER MIL-G-45204, TYPE II, 0.13μm [.000005] MIN THK. OVER NICKEL PLATE PER QQ-N-290 0.51μm-1.52μm [.000020-.000060] EXT THK.
- 4. RECOMMENDED HOLE SIZE, PLATED OR UNPLATED:
 MACHINE INSERTION: 1.04±0.03 [.041±.001]
 HAND INSERTION: 1.04 ^{+0.10}/_{-0.00} [.041^{+.004}/_{-.000}]
- 5. APPLICATION TOOL PART NUMBER:
 MACHINE NO. 682127-2
 INSERTION HEAD NO. 682039-1
- 6. TO INSURE PROPER SPRING TENSION DO NOT EXCEED A 0.10 [.004] DIFFERENCE IN PIN DIA WHEN CHANGING TO A SMALLER PIN.
- 7. BOTTOM PLUG KNOCKOUT TOOL PART NUMBER 69729 WITH TIP PART NUMBER 69728.
- 8. MATERIAL; SPRING: BERYLLIUM COPPER (QQ-C-533)
 EYELET: COPPER (QQ-C-576)

SUPSD BY	OBsolete	OPEN	RECOMMENDED PIN DIA	FINISH	PART NO
1-332095-9	OBsolete	OPEN	0.33-0.51 [.013-.020]	TIN	2-332095-6
1-332095-9	OBsolete	KNOCKOUT	0.41-0.48 [.016-.019]	TIN	2-332095-5
1-332095-9	OBsolete	CLOSED			2-332095-4
1-332095-9	OBsolete	OPEN	0.33-0.51 [.013-.020]	GOLD	2-332095-3
1-332095-9	OBsolete	KNOCKOUT			2-332095-2
1-332095-9	OBsolete	CLOSED			2-332095-1
2-332095-6	OBsolete	OPEN	0.33-0.41 [.013-.016]	TIN	2-332095-0
2-332095-6	OBsolete	KNOCKOUT	0.33-0.51 [.013-.020]	TIN	1-332095-9
2-332095-6	OBsolete	CLOSED			1-332095-8
2-332095-4	OBsolete	CLOSED			1-332095-7
2-332095-3	OBsolete	OPEN	0.33-0.41 [.013-.016]	GOLD	1-332095-6
2-332095-2	OBsolete	KNOCKOUT			1-332095-5
2-332095-1	OBsolete	CLOSED			1-332095-2
1-332095-2	OBsolete	CLOSED	0.33-0.51 [.013-.020]	TIN	1-332095-2
1-332095-2	OBsolete	CLOSED	0.33-0.41 [.013-.016]	TIN	332095

THIS DRAWING IS A CONTROLLED DOCUMENT.		DWN R.TALLEY 4-5-91	Tyco Electronics Corporation Harrisburg, Pa 17105-3608	
DIMENSIONS: mm [INCHES]	TOLERANCES UNLESS OTHERWISE SPECIFIED:	CHK -	APVD -	NAME
0 PLC ± -	1 PLC ± -	PRODUCT SPEC -	APPLICATION SPEC -	MINIATURE SPRING SOCKET ASSEMBLY SERIES 1
2 PLC ± -	3 PLC ± 0.20 [.008]	WEIGHT -	SCALE A2	CAGE CODE 00779
4 PLC ± -	ANGLES ± -	CUSTOMER DRAWING	DRAWING NO C=332095	RESTRICTED TO -
MATERIAL 8-	FINISH SEE TABLE	SCALE 20:1	SHEET 1 OF 1	REV AA1